

Number	S5LE/QTY.	DESCRIPTION
---	1	---
01-4030	2	1/4 -20 UNC x 1 Wiz Lock Bolt
01-4038	1	BUTTON HEAD SOCKET CAP SCREW, 1/2 -13 x 2 1/2"
03-2020	2	1/4" Lock Nut
07-8363	2	IDLER PULLEY SPACER
07-9891	2	SHEETMETAL SHIELD
09-2060	1	1 1/2 X 3 11 GA FRAME PLUG
09-3063	6	7/16" DIA HOLE PLUG
09-5046	2	Nitro Plus Footpad
09-8330	1	REDIRECTIONAL PULLEY 4"
12-1026	2	KEEP HANDS AWAY
12-1164	1	WARNING DECAL, MINI WEIGHT SELECTOR PIN
12-5453	1	BACK PLACARD S5LE (NEW LOGO)
12-5464	1	FRONT PLACARD S5LE (NEW LOGO)
12-5611	1	Standard Nautilus Transfer Decal
17-1260	2	STANDARD 45" GUIDE ROD
19-1015	4	2" Square Duo-Loc
BF601	1	SIDE FRAME
OPT-AW	1	Add On Weight Assembly
OPT-WT-04	1	WEIGHTSTACK ASSEMBLY #04
Shield Assembly-Painted	1	SHIELD ASSEMBLY

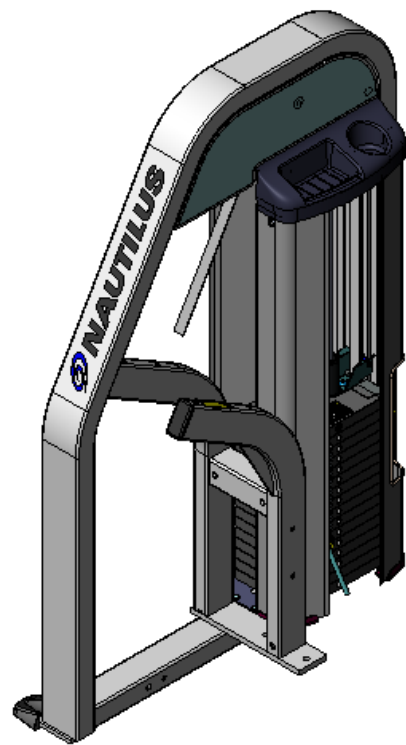

Number	S5 NITRO LE/QTY.	DESCRIPTION
02-9220	2	3/8 -16 UNC x 1 1/4 Bolt
01-1282	1	1/2 -13 UNC x 1 1/2 Bolt
01-1461	5	1/2 -13 UNC x 6 1/2 Bolt
01-1552	3	3/8 -16 UNC x 4 Bolt
02-3055	8	SCREW, SET, 1/4 -28 UNF x 1/4
02-9250	8	3/8 -16 UNC x 2 1/4 Bolt
03-1035	7	3/8" Lock Nut
03-1055	7	1/2" Lock Nut
04-5207	1	WASHER, FLAT, 1/2" SAE
04-5213	20	3/8" Internal Loc Washer
04-5214	10	1/2" Internal Loc Washer
05-5105	2	.500 ID Bushing (IGUS Replacement)
07-9417	4	SEAT BACK PIVOT
07-9430	1	SEAT BACK ADJUSTMENT
07-9431	1	LOWER LINKAGE SB ADJ.
08-5096	1	SEAT RACK BUSHING
09-1004	1	.500 ID X 3" CLOSED END
09-1115	2	HAND GRIP 7/8 X 8 1/2
09-2040	2	1 1/2 X 2 11 GA FRAME PLUG
09-2060	1	1 1/2 X 3 11 GA FRAME PLUG
09-3055	1	2 X 4 11 GA FRAME PLUG
09-3064	1	1/2" DIA HOLE PLUG
09-4077	8	BEARING 1 1/2 SQ X 3/4 ID
09-5030	1	FOOTPAD MOLDED BLACK
09-5045	2	NITRO SERIES MOLDED FOOTPAD
09-5046	2	Nitro Plus Footpad
09-9530	2	GRIP RING .905 ID (FOR 7/8" BAR)
09-9560	2	GRIP CAP .905 ID (FOR 7/8" BAR)
10-1060	1	Extension Spring
12-1026	1	KEEP HANDS AWAY
12-1145	1	SEAT BACK ADJ. DECAL
12-1380	1	MADE IN USA
HB601	1	SEAT ADJUSTMENT RACK
SF659	1	NITRO LE SEAT FRAME
SF660	1	SEAT BACK
UP8237	1	STD TALL TOP BACK PAD
UP8238	1	LOWER CONTOURED BACK PAD
UP8440-UP9537	1	SLE SEAT BOTTOM

Number	Nitro Plus/QTY.	DESCRIPTION
06-8285	1	Snap Ring, No Nautilus Number
02-9220	1	3/8 -16 UNC x 1 1/4 Bolt
01-1548	3	3/8 -16 UNC x 3/4 Wiz Lock Bolt
02-9250	1	3/8 -16 UNC x 2 1/4 Bolt
03-1055	4	1/2" Lock Nut
03-4142	1	5/16" Jam Nut
03-5103	1	3/8" Hex Nut
04-2095	1	WASHER
04-5213	1	3/8" Internal Loc Washer
04-5214	4	1/2" Internal Loc Washer
05-1225	2	FLANGE BEARING
07-8280	1	LOCK PIN
07-9916	1	Pillow Block Bearing Cover
07-9917	1	P B Bearing Cover w/ Hole
07-9919	1	COUNTER WEIGHT
08-2056	2	MOLDED SHAFT SPACER
09-2020	1	1 1/2 SQ 11 GA FRAME PLUG
09-3062	1	3/8" DIA HOLE PLUG
09-3098	1	VINYL CAP 1" ID X 3/4 RED
09-4004	1	MOLDED UPH. ROLLER END CAP
09-4092	1	BUMPER
09-8000	1	Belt Keeper
09-8135	1	T-knob, Yellow 5/16-18
10-2020	1	SPRING COMPRESSION .49 OD 1.5 L
12-1129	1	LE/LCP MA DECAL
19-1575	2	BEARING - PILLOW BLOCK 1"
30-2120	1	1 3/4 ID BUSHING
MA600	1	NITRO PLUS LE MOVEMENT ARM
MA601	1	ADJUSTABLE PAD MOUNT
UP9824	1	LEG ROLLER
LK631	1	BELT CLAMP
01-4091	4	BUTTON HEAD SOCKET CAP SCREW 0.375 -16 UNC x 2 1/4" BRIGHT ZINC

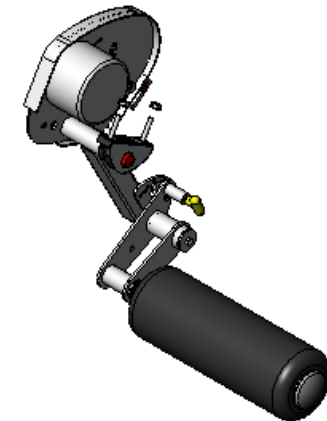

**Date: 02/26/07**

## **S5LE Leg Extension Parts List**





Number	S3LE/QTY.	DESCRIPTION
---	1	---
01-4030	2	1/4 -20 UNC x 1 Wiz Lock Bolt
01-4038	1	BUTTON HEAD SOCKET CAP SCREW, 1/2 -13 x 2 1/2"
03-2020	2	1/4" Lock Nut
07-8363	2	IDLER PULLEY SPACER
07-9891	2	SHEETMETAL SHIELD
07-9990	1	Weight Stack Shield Assy
09-2060	1	1 1/2 X 3 11 GA FRAME PLUG
09-3063	6	7/16" DIA HOLE PLUG
09-5045	2	NITRO SERIES MOLDED FOOTPAD
09-8330	1	REDIRECTIONAL PULLEY 4"
12-1026	2	KEEP HANDS AWAY
12-1102	1	WEIGHTSTACK 4 3/4 PIN WARNING DECAL
12-1164	1	WARNING DECAL, MINI WEIGHT SELECTOR PIN
12-5553	1	PLACARD BACK BF601 (NEW LOGO)
12-5568	1	PLACARD S3LE REVISED (NEW LOGO)
12-5611	1	Standard Nautilus Transfer Decal
17-1260	2	STANDARD 45" GUIDE ROD
19-1015	4	2" Square Duo-Loc
48-1095	1	TREAD STRIP ARMOR
BF601	1	SIDE FRAME
OPT-AW	1	Add On Weight Assembly
OPT-WT-04	1	WEIGHTSTACK ASSEMBLY #04

Number	S3 NITRO LE/QTY.	DESCRIPTION
02-9220	2	3/8 -16 UNC x 1 1/4 Bolt
01-1115	2	3/8 -16 UNC x 2 1/2 Bolt
01-1282	1	1/2 -13 UNC x 1 1/2 Bolt
01-1461	5	1/2 -13 UNC x 6 1/2 Bolt
01-1552	3	3/8 -16 UNC x 4 Bolt
02-3055	8	SCREW, SET, 1/4 -28 UNF x 1/4
02-9250	6	3/8 -16 UNC x 2 1/4 Bolt
03-1035	7	3/8" Lock Nut
03-1055	7	1/2" Lock Nut
04-5207	1	WASHER, FLAT, 1/2" SAE
04-5213	20	3/8" Internal Loc Washer
04-5214	10	1/2" Internal Loc Washer
05-5105	2	.500 ID Bushing (IGUS Replacement)
07-9417	4	SEAT BACK PIVOT
07-9430	1	SEAT BACK ADJUSTMENT
07-9431	1	LOWER LINKAGE SB ADJ.
08-5096	1	SEAT RACK BUSHING
09-1004	1	.500 ID X 3" CLOSED END
09-1115	2	HAND GRIP 7/8 X 8 1/2
09-2040	2	1 1/2 X 2 11 GA FRAME PLUG
09-2060	1	1 1/2 X 3 11 GA FRAME PLUG
09-3055	1	2 X 4 11 GA FRAME PLUG
09-3064	1	1/2" DIA HOLE PLUG
09-4077	8	BEARING 1 1/2 SQ X 3/4 ID
09-5030	1	FOOTPAD MOLDED BLACK
09-5045	2	NITRO SERIES MOLDED FOOTPAD
09-9530	2	GRIP RING .905 ID (FOR 7/8" BAR)
09-9560	2	GRIP CAP .905 ID (FOR 7/8" BAR)
10-1060	1	Extension Spring
12-1026	1	KEEP HANDS AWAY
12-1145	1	SEAT BACK ADJ. DECAL
12-1380	1	MADE IN USA
HB601	1	SEAT ADJUSTMENT RACK
SF659	1	NITRO LE SEAT FRAME
SF660	1	SEAT BACK
UP8075-UP9538	1	SLC SEAT PAD
UP8237	1	STD TALL TOP BACK PAD
UP8238	1	LOWER CONTOURED BACK PAD
UP8430	1	BACK PAD UPHOLSTERY
UP8440-UP9537	1	SLE SEAT BOTTOM

Number	S3LE MVMT ARM/QTY.	DESCRIPTION
06-8285	1	Snap Ring, No Nautilus Number
02-9220	1	3/8 -16 UNC x 1 1/4 Bolt
01-1548	3	3/8 -16 UNC x 1/4 Wiz Lock Bolt
02-9250	1	3/8 -16 UNC x 2 1/4 Bolt
03-1055	4	1/2" Lock Nut
03-4142	1	5/16" Jam Nut
03-5103	1	3/8" Hex Nut
04-2095	1	WASHER
04-5213	1	3/8" Internal Loc Washer
04-5214	4	1/2" Internal Loc Washer
05-1225	2	FLANGE BEARING
07-8280	1	LOCK PIN
07-9916	1	Pillow Block Bearing Cover
07-9917	1	P B Bearing Cover w/ Hole
07-9919	1	COUNTER WEIGHT
08-2056	2	MOLDED SHAFT SPACER
09-2020	1	1 1/2 SQ 11 GA FRAME PLUG
09-3062	1	3/8" DIA HOLE PLUG
09-3086	1	HOLE PLUG 2 OD X 1.5 ID X .75
09-3098	1	VINYL CAP 1" ID X 3/4 RED
09-4092	1	BUMPER
09-8000	1	Belt Keeper
09-8135	1	T-knob, Yellow 5/16-18
10-2020	1	SPRING COMPRESSION .49 OD 1.5 L
12-1129	1	LE/LCP MA DECAL
19-1575	2	BEARING - PILLOW BLOCK 1"
30-2120	1	1 3/4 ID BUSHING
MA600	1	NITRO PLUS LE MOVEMENT ARM
MA601	1	ADJUSTABLE PAD MOUNT
UP9824	1	LEG ROLLER
LK631	1	BELT CLAMP
01-4091	4	BUTTON HEAD SOCKET CAP SCREW 0.375 -16 UNC x 2 1/4" BRIGHT ZINC

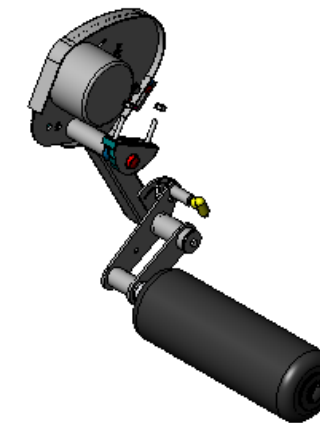
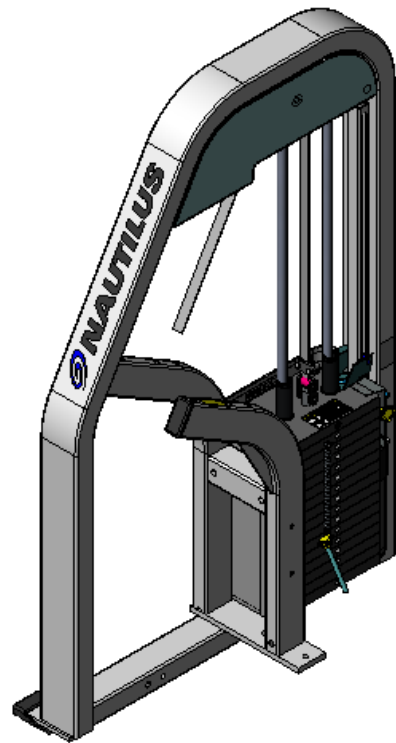

**Date: 02/26/07**

# **S3LE Leg Extension Parts List**



**RED: PAINTED ITEMS**  
**Trollies / Machine**

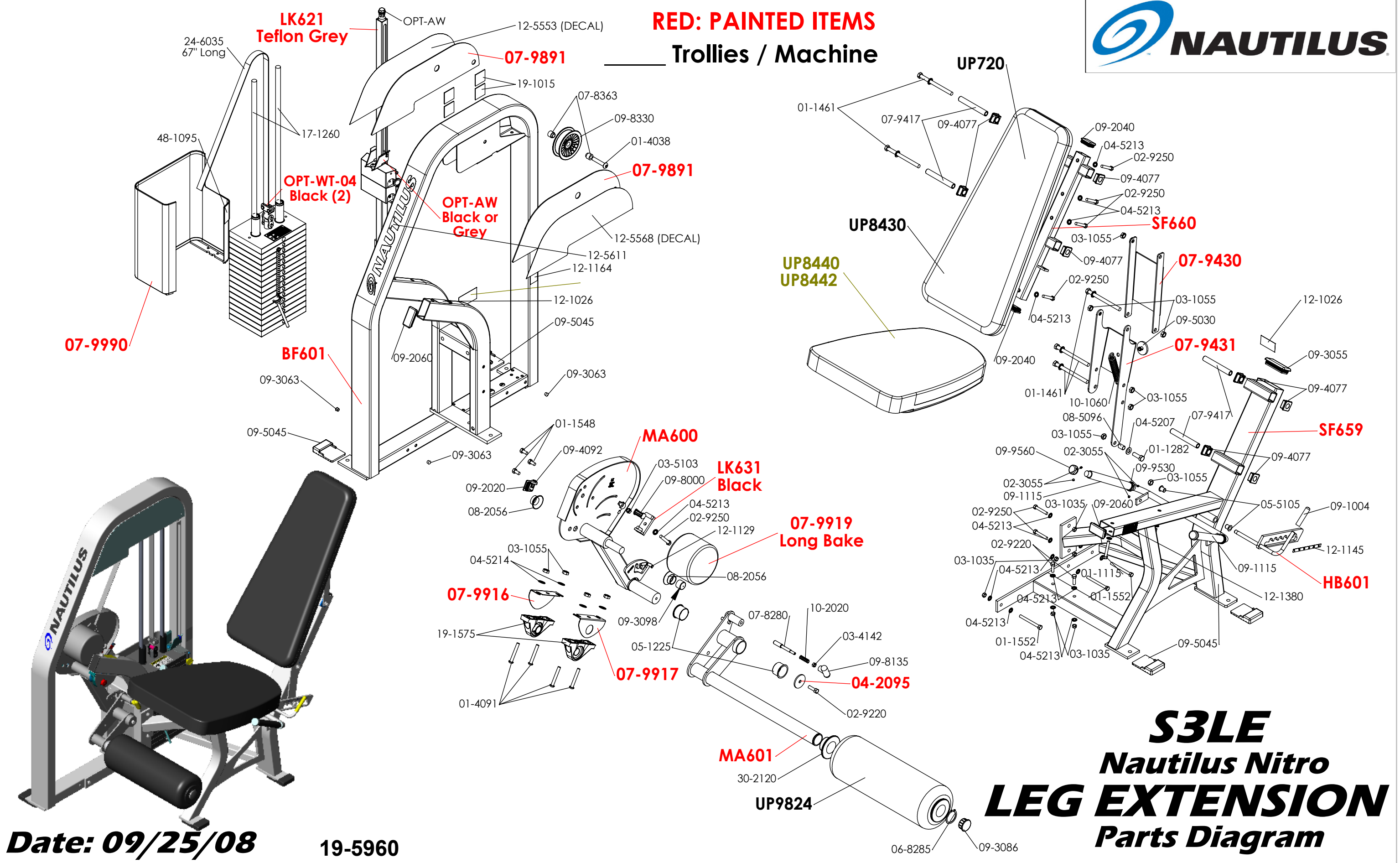

**Date: 09/25/08**

**19-5960**

**S3LE**  
**Nautilus Nitro**  
**LEG EXTENSION**  
**Parts Diagram**